

NAKARIN

80CM COFFEE TABLE

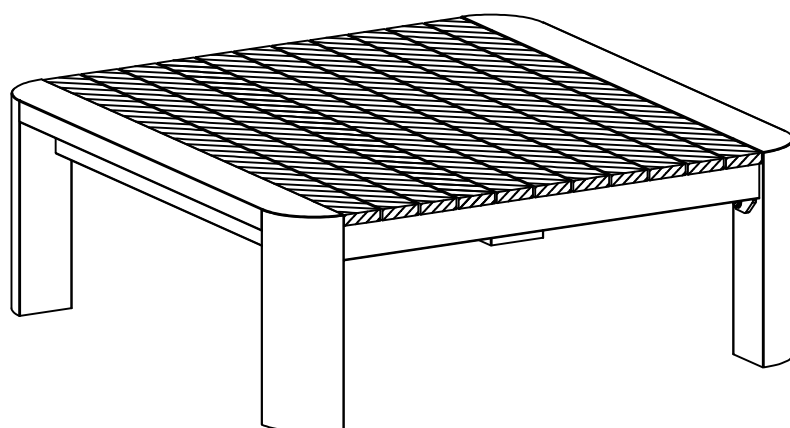

ASSEMBLY PARTS

① Leg frame = 2 pcs

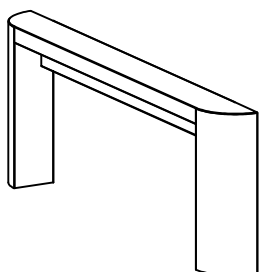

② Top frame = 1pc

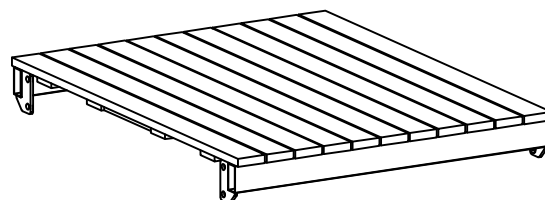

ASSEMBLY TOOLS

① A F-Bolt 8x20 mm = 8 pcs

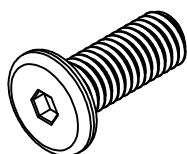

② B Plain Washer 8.5x18x1 mm = 8 pcs



③ C F-Bolt 6x20 mm = 4 pcs

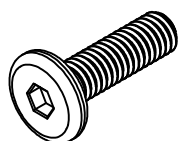

④ D Plain Washer 6.5x18x1 mm = 4 pcs



⑤ E Support pat = 2 pcs

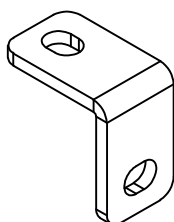

⑥ F Allen key 4x98 mm = 1 pc

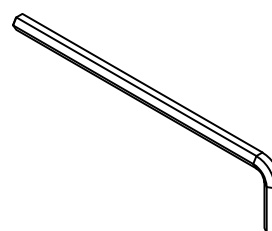

ASSEMBLY INSTRUCTIONS

STEP 01

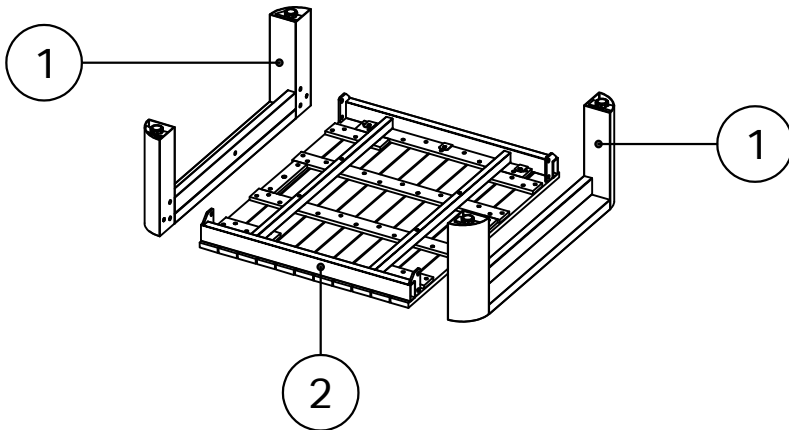

STEP 02

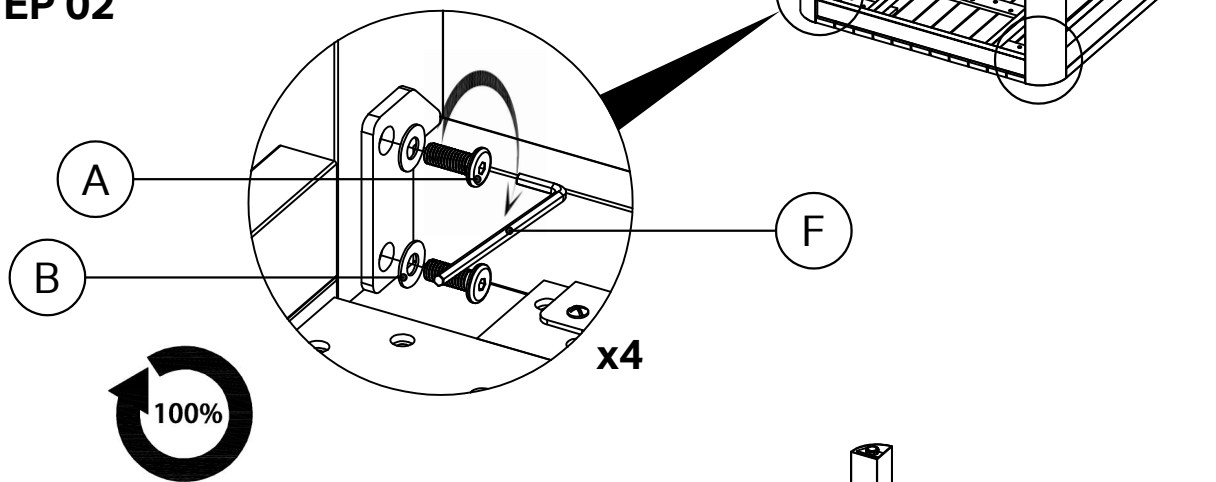

STEP 03

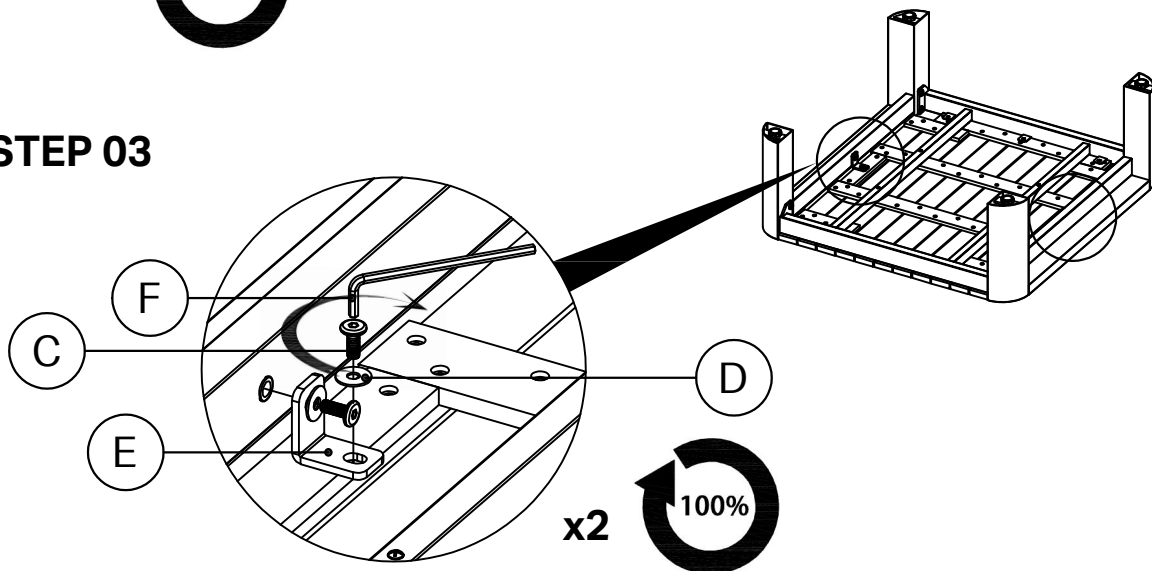

STEP 04

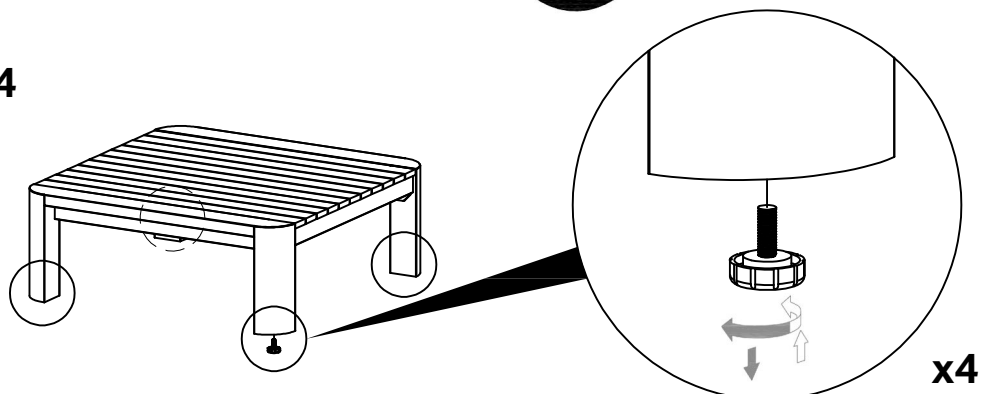

CHARACTERISTICS OF TEAK

- Teak furniture is suitable for outdoor living. With regular maintenance, it can last for many years. Due to natural variations in the wood, each product and finish may vary slightly.
- When exposed to sun and rain, the color of teak will change to a silver-grey patina. This is part of the teak's life cycle.
- We support responsible timber sourcing and aim to work harmoniously with the environment. We are certified by the Forest Stewardship
- Council® (FSC), which promotes environmentally, socially, and economically responsible forest management.
- Teak furniture offers comfort, style, and functionality for various uses
- such as entertaining, relaxing, and enjoying outdoor spaces.

MAINTENANCE

- Use a dry, clean cloth to dust furniture weekly.
- For spot cleaning, spray off debris with a hose and brush off dirt or debris with a soft-bristle brush. Dry with a soft cloth.
- New teak may have oil surfacing that looks like water marks; these can be removed by gentle washing.
- For thorough cleaning, use Golden Care® Hardwood & Teak Cleaner. Clean furniture periodically and before storing.
- Additionally, consider using: Golden Care® Teak Shield –
- Penetrates and protects teak and other hardwood furniture from water and stains, and helps protect against mould, mildew, and UV rays. Golden Care® Teak Protector – Helps maintain the original colour of the
- teak longer.
- Avoid letting water stand on furniture surfaces and cushions.
- Protect furniture by covering or storing it when not in use
- for extended periods. Clean and dry furniture thoroughly before covering. Store cushions in a dry place if possible.
- In order to prolong your wicker furniture looking great and to protect it we recommend Golden Care® Wicker Protector.
- Clean cushions thoroughly with Golden Care® Multi Surface Cleaner 1 and Golden Care® Fabric Protector to maintain the new look and make the fabric repellent to dirt, water, and moisture.

WARRANTY

- Your furniture carries a limited 2 year guarantee from the date of purchase. We will repair or replace any product with faults caused by faulty workmanship.
- Damage caused by poor maintenance, acts of nature or accidents are not covered. All fabrics have a limited 12 month guarantee against manufacturing faults.